

## INSTRUCTIONS

# Gelish Art Form Ombre Flower



### Step 1

After painting nails with desired color, mix **ESSENTIAL WHITE** and **ESSENTIAL BLUE** onto a nail palette to create an ombre mixture.

### Step 2

Using a **SQUARE BRUSH** and the ombre mixture, paint flower petals.

### Step 3

With a **MINI STRIPER BRUSH** and Essential Blue, add shadows in between the petals. Cure for 30 seconds in the **18G LED Light**.

### Step 4

Mix **ESSENTIAL YELLOW** and Essential White onto a nail palette. Using the Mini Striper Brush, add several small dots in the middle of the flower.

### Step 5

Using Essential White and the Mini Striper Brush, outline the flower petals. Cure for 30 seconds.

### Step 6

Apply a thin coat of **TOP IT OFF** to the entire nail making sure to cap the free edge. Cure for 30 seconds. With **NAIL SURFACE CLEANSE** and **WIPE IT OFF** lint-free wipes, cleanse the inhibition layer. Massage **NOURISH** Cuticle Oil into the skin surrounding the nail plate. Enjoy your finished look.

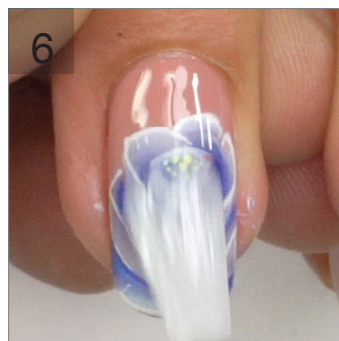
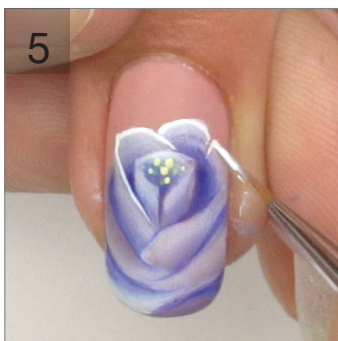
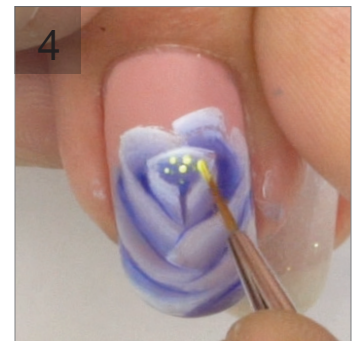
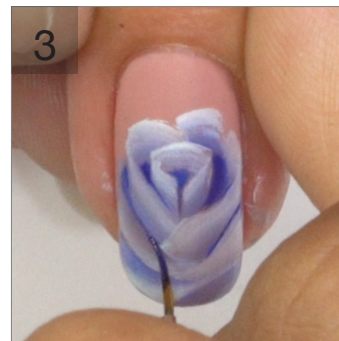

gelish.  
**SART**  
**FORM GEL**  
**2D TECHNOLOGY™**